

Stimson House

project Stimson House
location Helford River, Cornwall.
client Charles Stimson
dates 2001 to present. Planning Application lodged
cost £300,000

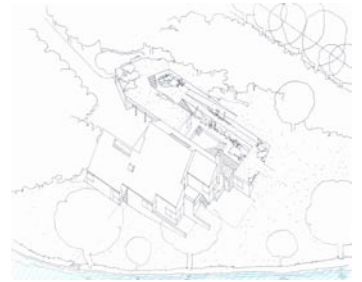

The site is in an area of outstanding natural beauty. The client wants a house which is 'green' in every respect.

The site facing the river is left as a wildflower meadow. Behind the house, to the south, a terraced flower and vegetable garden is created.

Materials are slate, granite and green oak.

